

Valve Technology, Traction force range 500 N to 5,000 N (extended up to 7,000 N)

End Fitting

Standard Dimensions

End Fitting

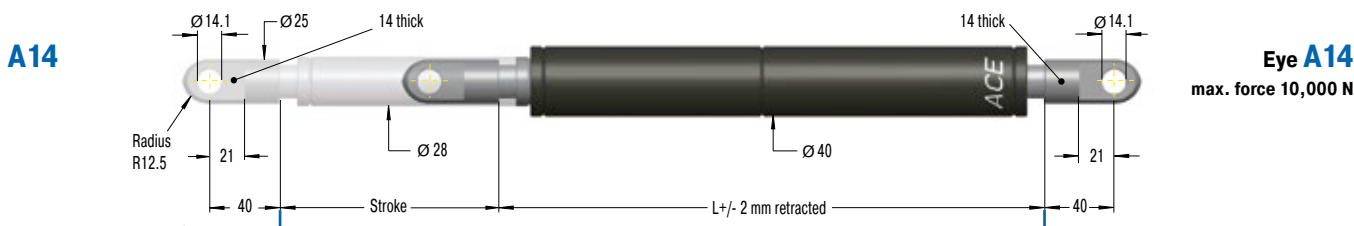

B14

Stud Thread B14

C14

Angle Ball Joint C14

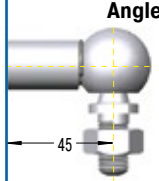
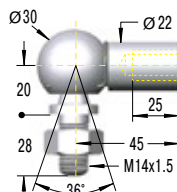

D14

Clevis Fork D14

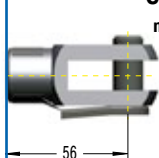
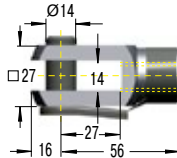

E14

Swivel Eye E14

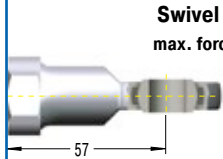
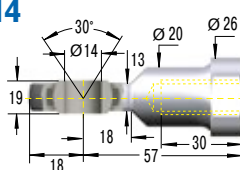

Performance and Dimensions

TYPES	Stroke mm	L retracted mm	Traction Force Range max. N
GZ-40-100	100	250	5,000
GZ-40-150	150	325	5,000
GZ-40-200	200	400	5,000
GZ-40-250	250	475	5,000
GZ-40-300	300	550	5,000
GZ-40-400	400	700	5,000
GZ-40-500	500	850	5,000
GZ-40-600	600	1,000	5,000

Ordering Example

GZ-40-150-EE-800

- Type (Pull Type) _____
- Body Ø (40 mm) _____
- Stroke (150 mm) _____
- Piston Rod End Fitting E14 _____
- Body End Fitting E14 _____
- Traction Force F_1 800 N _____

Mounting accessories see from page 200.

Rod Shroud W14-40

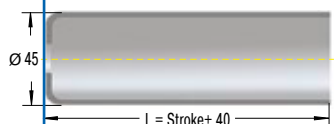

Adjuster Knob DE-GAS-14
See page 175.

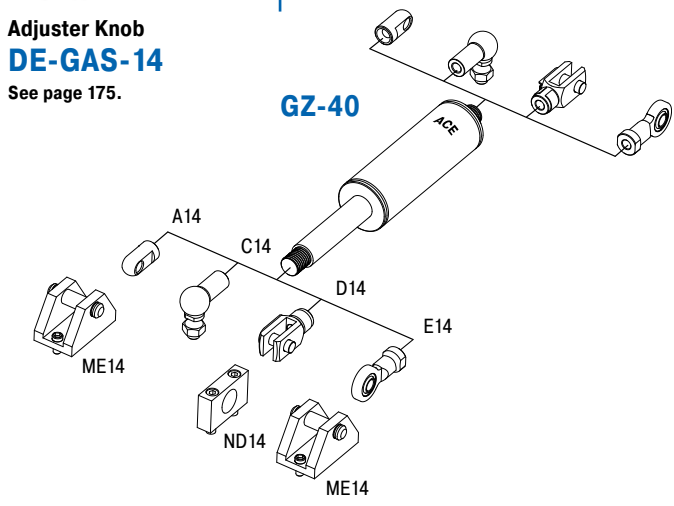

Technical Data

- Traction force range:** 500 N to 5,000 N (extended up to 7,000 N)
- Progression:** Approx. 40 %
- Lifetime:** Approx. 2,000 m
- Operating temperature range:** -20 °C to +80 °C
- Material:** Outer body, End fittings: Zinc plated steel; Piston rod: Steel with wear-resistant coating
- Mounting:** With piston rod upwards.
- End position damping length:** Without damping. For end position damping use damping material (e.g. TUBUS or SLAB).
- Positive stop:** External positive stop at the end of stroke provided by the customer.
- End fittings:** They are interchangeable and if necessary must be positively secured by the customer to prevent unscrewing.

Issue 07.2017 – Specifications subject to change