



BANJO BOLT MANIFOLDS



ADVANTAGES OF SUN BANJO BOLT MANIFOLDS

- Standard cavity for:
 - Counterbalance valves
 - Pilot to open check valves
 - Flow fuse valves
 - Flow control valves
 - 2/2 way directional valves
- Reduced piping
- Load holding valve can be mounted directly on the cylinder
- Direct mounting for high safety requirements
- For banjo bolts with male BSPP thread, metric thread on request
- Body rotatable
- High pressure banjo bolts (Parker Ermeto) with soft seal ring
- System pressure up to 350 bar (with cast iron bodies)

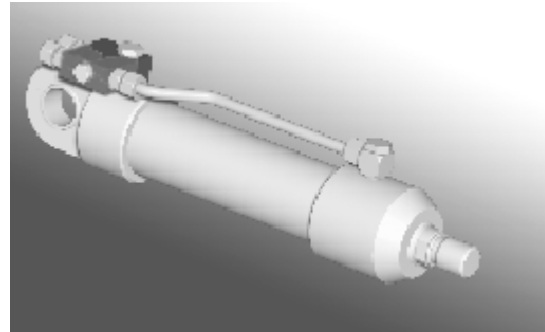

Example of use: X4C body with CK** valve

- Aluminium bodies optional for max. pressure 210 bar
- All manifolds come with banjo bolt and seal ring

INSTALLATION INSTRUCTIONS AND SPECIFICATIONS

Installation:
Recommended torque for banjo bolt 45 Nm to 49 Nm
(34-37 lb.ft.)

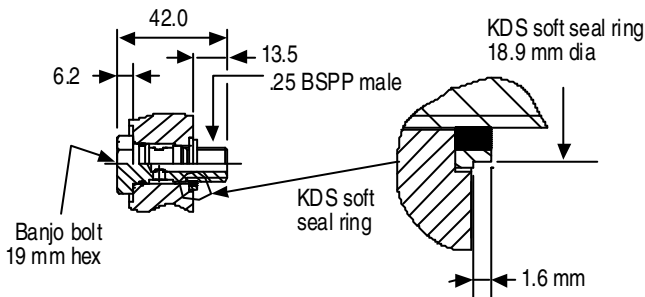

Installation:
Recommended torque for banjo bolt 70 Nm to 77 Nm
(52-58 lb.ft.)

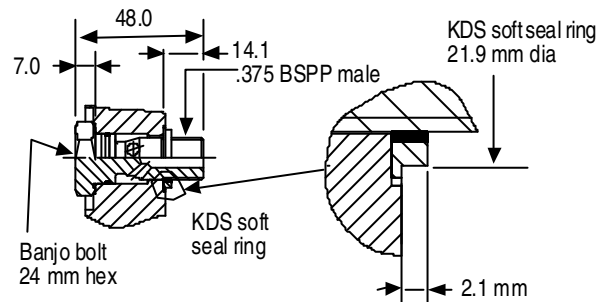

Installation:
Recommended torque for banjo bolt 120 Nm to 132 Nm
(90-99 lb.ft.)

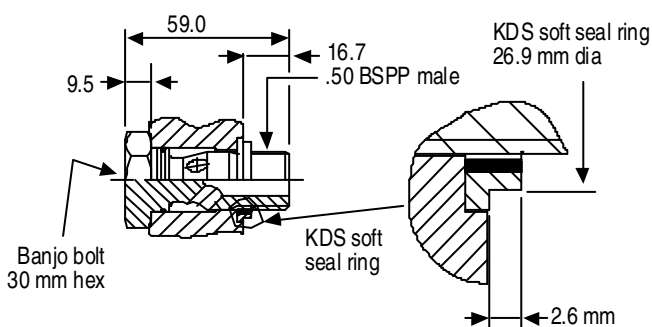

Installation:
Recommended torque for banjo bolt 230 Nm to 250 Nm
(172-187 lb.ft.)

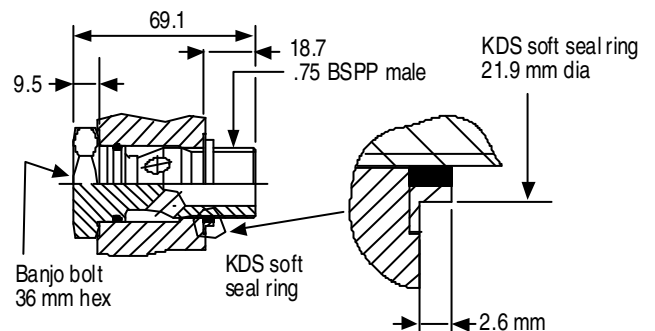

See SUN Hydraulics datasheets for standard settings, adjustment ranges, max. pressures, seal materials, torques etc.